

We have our registered Trademark ; SEMITÜRK®

- ISO 9001:2008 Quality Management Certified
- Vehicle Type Approval Certificates
- CE Certificate
- Active in Konya 2.Organized Industrial Zone with 12,000sqm production area
- Internataional Contracts with Suppliers / Clients such as:
 - Mercedes Germany (Bodywork Aggreement)
 - GTR Capital
 - Bertling Logistics
 - Turna Nakliyat
 - Ikra Logistics
 - Temsa
 - ROKETSAN
 - Otosan
 - GENERAL DIRECTORATE OF SECURITY
 - EMNİYET GENEL MÜDÜRLÜĞÜ



**Quality Pursuing
Professional Manner...**

BÜYÜKYÜKSEL DAMPER VE HİDROLİK MAK. SAN. TİC. LTD. ŞTİ.
2.Organize Sanayi Bölgesi Reisköy Caddesi No: 3 PK.: 42002
KONYA / TÜRKİYE Tel: +90 332 239 1860 Fax : +90 332 239 1864
www.yukseldamper.com - www.yukseldamper.com.tr
info@yukseldamper.com - info@yukseldamper.com.tr



About Us:

Büyüküksel Damper ve Hidrolik Mak. San.Tic. Ltd. Şti. went into action in 1989. Maintains its manufacturing operations accretively at current premises in 2nd Industrial Zone with 12.000 sqm production area after being active in Konya Karatay Sanayi and Bûsan Private Industrial Zone. We pride ourselves on contributing national economy. In 2005, it was awarded the letter of appreciation by Konya Chamber of Industry for “ Foreign Currency Saving Services” and “ High Level Tax Return”. And we are continuously enhancing quality standards.

Within the company, all the different variants of semi-trailers, dumpers, tanker semi-trailers and lowbeds are being manufactured.

Our products are being operated in 3 continents notably in Middle-East. We soon aimed to add new ones to our customers totally in 18 countries as particularly 5 European, 10 Asian and 3 African countries.

Our mission ; Is to be your solution partner in accordance with your request by serving our products on time with an optimal price, without making any concessions on our quality.

Our vision ; Is to be one of the market leaders with its brand recogniton in semi-trailer and transportation business.



www.yukseldamper.com



Leading company in the sector with its proliferous network...



Our Core Competency:

- To have the strategy of following the latest developments in the sector,
- To be active in national and international market,
- Flexibility and reliability in our project designs,
- Creativity in design proposals,
- Very good experience in manufacturing for heavy duty conditions,
- Good communication skills in international business and trade with an intelligent team,
- To make supplementary co-operations with different manufacturers,
- To engage with supplementary manufacturers on procurement of qualified and affordable priced goods.



Projects and R&D Operations;

As well as manufacturing standard products in the sector, our firm also works on Project-basis. Within this scope we successfully realized an R&D Project supported by TUBİTAK-TEYDEB for a BOTTOM HOPPER TYPE SEMI-TRAILER SET with aluminum bunker and made the sales commitment of this product with a foreign company.

With performing the R&D operations, a hydraulic steering lowbed with hydraulic suspension and hydraulically moving goose-neck was manufactured and exported. The R&D operations for hydraulic motion modular semi-trailers are still in progress.

Furthermore, a "mobile cinema"/"training vehicle" semitrailer- especially demanded by public institutions- was designed by our staff and was delivered.

A vehicle to be used for military purposes was successfully finished and delivered to Roketsan Missiles Industries of which we can not give any information because of a confidentiality agreement and new products will be realized due to the corporation's needs. Also, 7 pcs mobile traffic control station semi-trailer with living rooms were delivered to General Directorate of Security to be used in high-ways.



SEMITÜRK®



MODEL:
STPT000001

HYDRAULIC RAMP



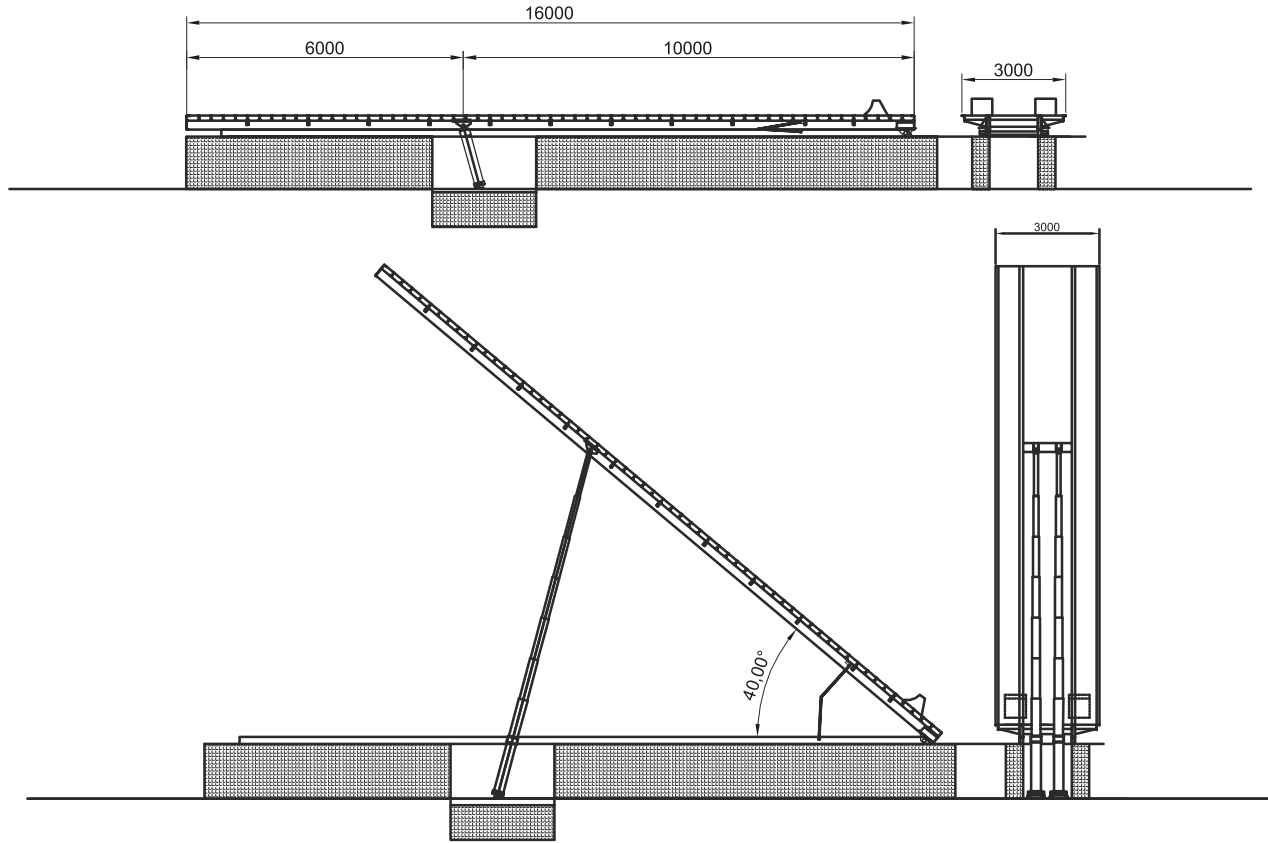

SEMITÜRK

HYDRAULIC RAMP**STPT000001**

- Designed for TIR/Truck Loading &Unloading Operations, 60 ton lifting capacity,
- There is a balance arm on the platform to be used against unbalanced loads and axis inter-shaft is reinforced with a crosswise system,
- Double lift- single controlled, parallel system,
- Trailer mount rings are available at the front of platform,
- Evacuation system will be limited to 38 degree angle to remove the dumper,
- There is a manual lowering on the platform in case of power cut,
- Distichous Wheel holders for the trailer and truck.

Hydraulic unit and control panel:

- Main engine has an electric power of 22kw with 3x380 volt,
- The PLC controlled system is in a special panel with Telemecanique brand conductors,
- Oil cooler radiator for hydrolic system,
- Gear type pump,
- 120 micron filter,
- Oil tank cover and the ventilation is available,
- Seamless steel pipes are used in hydraulic system and hoses are SAE 100R2

SEMITÜRK®



MODEL:
STAU00ET01

MODEL:
STAU00CT01

MODEL:
STAU00UT01

OVER CHASSIS TIPPER AND EQUIPMENTS



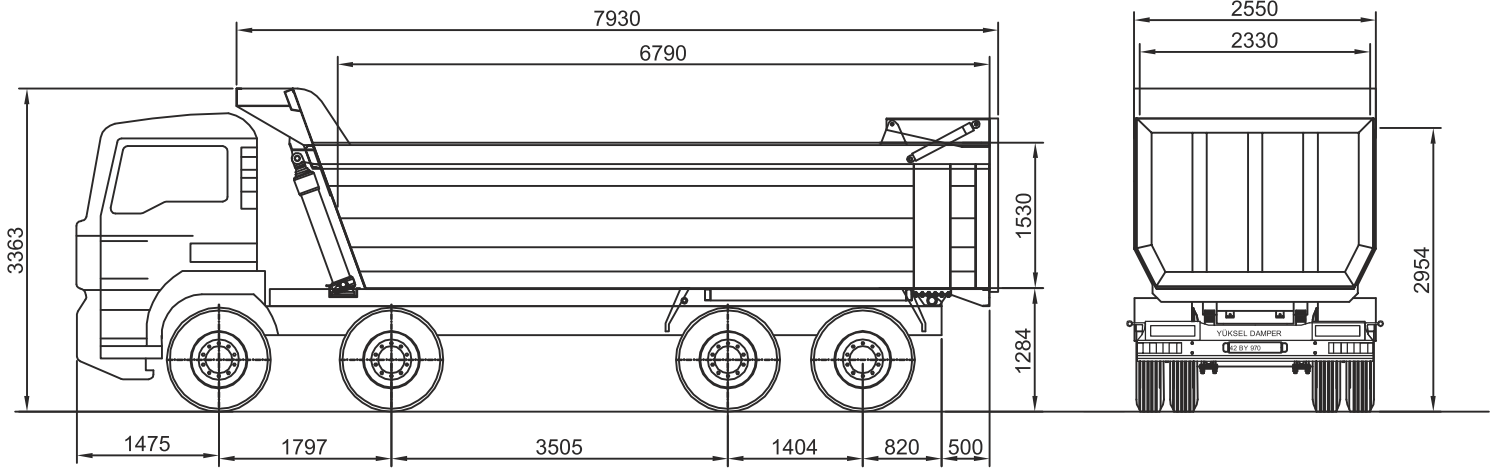

SEMITÜRK

OVER CHASSIS TIPPER STAU00ET01		STAU00UT01	STAU00CT01	
Weight and Dimensions	Model Type	Excavation type	'U' type	Chest type
	Length of Dumper	Appropriate to vehicle dimensions	Appropriate to vehicle dimensions	Appropriate to vehicle dimensions
	Gates	Optional sizes	Optional sizes	950 mm - 350 + 350 mm accessional gates
Main Structure and Chassis		Main structure, chassis and others are made of 'Domex 700' 'Hardox' and 'ST52' metal options	Main structure, chassis and others are made of 'Domex 700' 'Hardox' and 'ST52' metal options	Main structure, chassis and others are made of 'Domex 700' and 'ST52' metal options
Hydraulic System		<ul style="list-style-type: none"> Oil tank Limit control valve Directional valve and oil filter Power pump with coupling gear 4 - step cold drawn telescopic cylinder in the front 		
Additional Options		Hydraulic rear gate		
Standard Accessories		1 x tool box, 1 x water tank, FRP & metal mudguard, ladder		

SEMITÜRK®



MODEL:
STCL30A212

MODEL:
STCH30A212

CHEST TYPE DUMPER SEMI-TRAILER



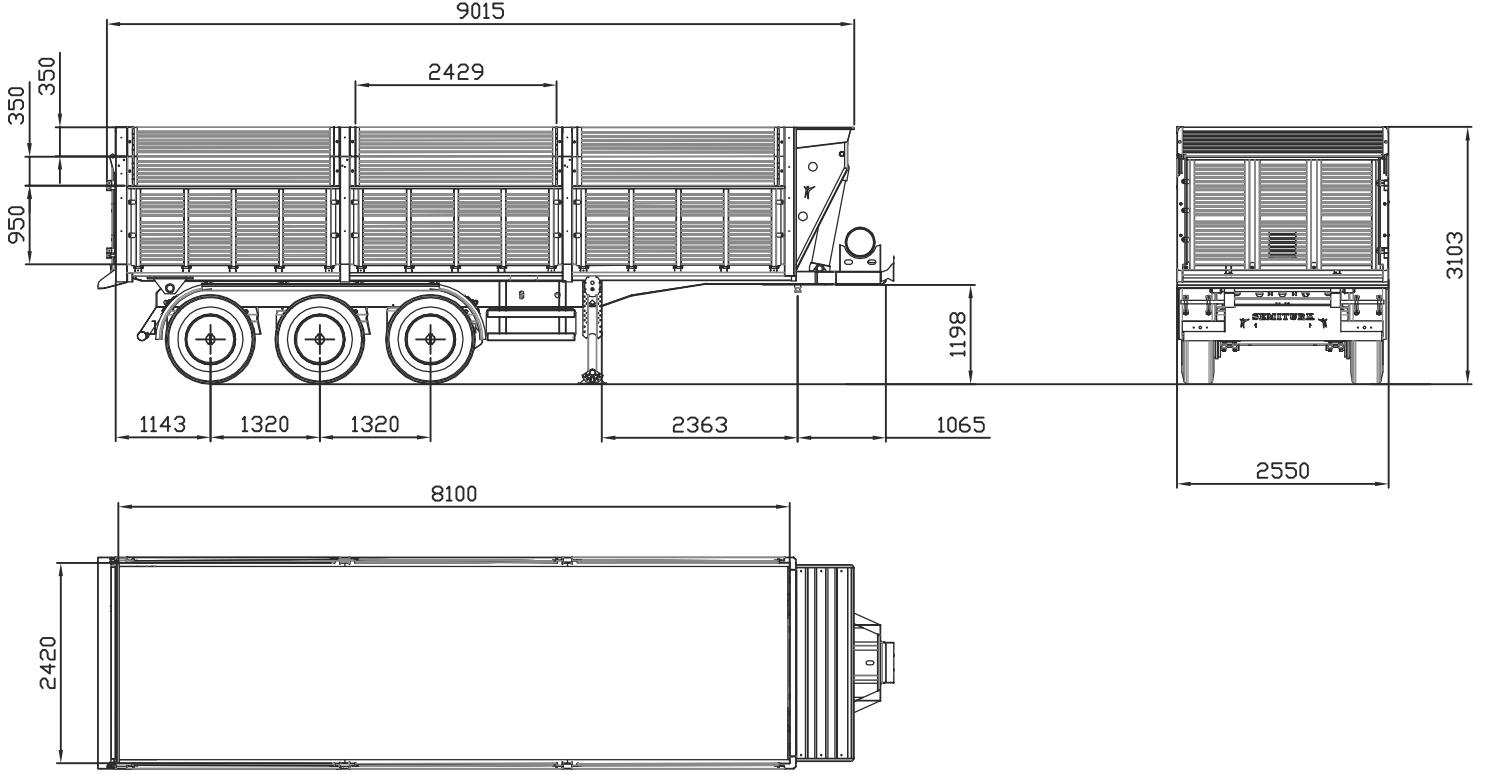

SEMITÜRK

SEMI-TRAILER		STCL30A212	STCH30A212
Weight and Dimensions	Length of Dumper	8.100 mm	8.100 mm
	Total Width	2.550 mm	2.550 mm
	Gates	950 mm	950 mm
	Accessional Gates	350 + 350 mm	350 + 350 mm
	Dead Weight	6.200 kg	7.200 kg
Main Structure and Chassis		Main structure, chassis and others are made of 'Domex 700'. Gates and accessional gates are made of 'Domex Docol'	Main structure, chassis and others are made of 'Domex 700'. Gates and accessional gates are made of 'Domex Docol'
Tires		385 / 65 R 22.5" size 6 + 1 units tubeless tires	
Brake System		Dual circuit brake hardware, EBS, 2S/2M & 4S/2M	
King Pin		2", bolt - connected in DIN standards	
Landing Gears		Telescopic landing gears with two mechanical speeds; Dynamic: 25.000 kg, Static : 50.000 kg	
Axles		3 axles BPW compatible, 12 ton capacity, square section	
Suspension System		Air - suspension "5813", 100 mm Z-type springs, suspension valves and shock absorbers	
Electricity Hardware 'E certified'		24 V Lighting system, 7 pole distribution cable and required hardware for traffic regulation	
Standard Accessories		1 x spare tire holder, 1 x tool box, 1 x water tank, wheel chock and holder, FRP mudguard, ladder	

SEMITÜRK®



MODEL:
STET20B420

MODEL:
STET30S440

EXCAVATION TYPE DUMPER SEMI - TRAILER



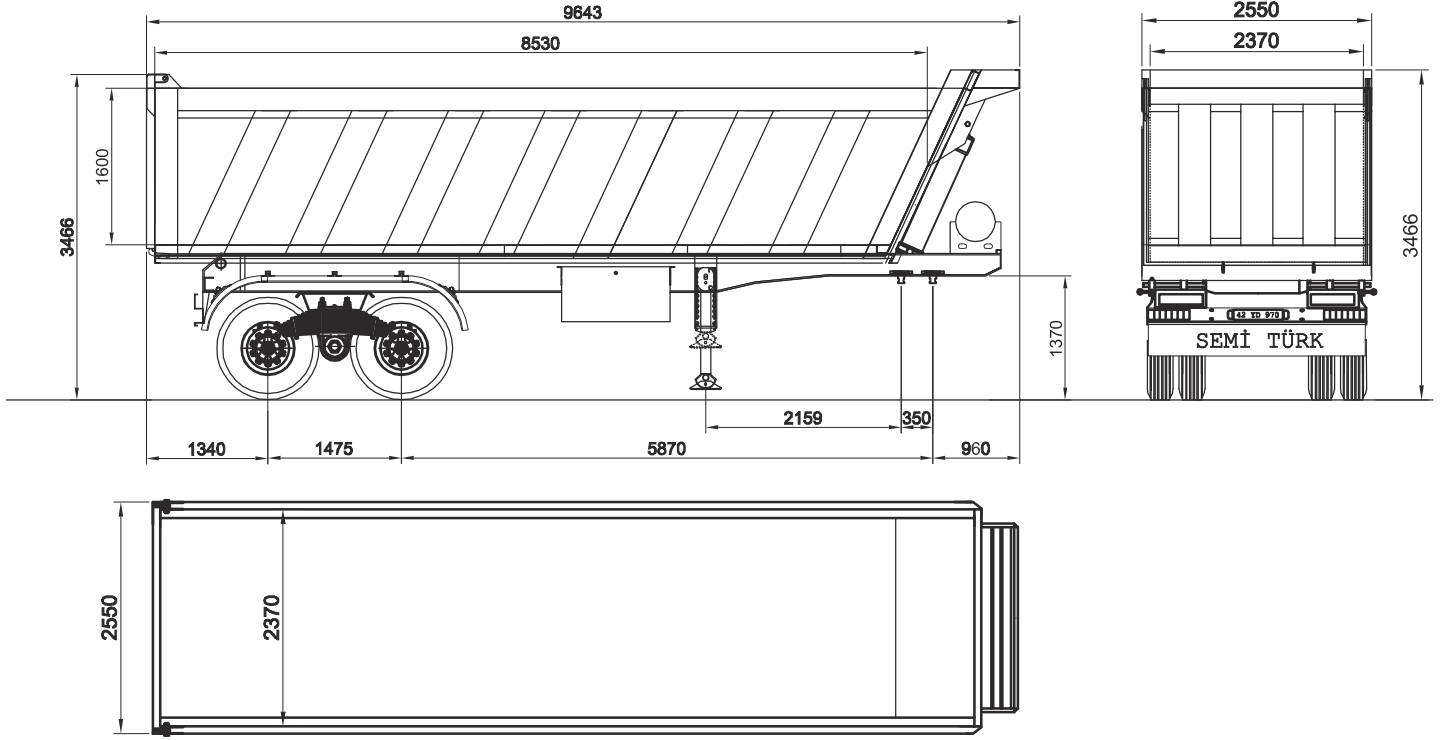

SEMITÜRK

DUMPER SEMI - TRAILER		STET20B420	STET30S440
Weight and Dimensions	Volume	32 m ³	43 m ³
	Length of Dumper	8.530 mm	9.410 mm
	Total Width	2.550 mm	2.800 mm
	Gate's Height	1.600 mm	1.706 mm
	Dead Weight	10.500 kg	13.000 kg
Undercarriage	Axles	2 x 16 ton capacity 'BPW compatible'	3 x 16 ton capacity 'BPW compatible'
	Suspension	Heavy duty 'tandem system'	100 x 12 mm spring suspension
	Tires	Dimensions of 12 R 22.5" 2 x 4 = 8 units Dimensions of 1200 x 24" 2 x 4 = 8 units	Dimensions of 1200 x 20" 3 x 4 = 12 units Dimensions of 1200 x 24" 3 x 4 = 12 units
Main Structure and Chassis		Manufactured from 'ST52' material with using submerged welding machine	
Brake System		Dual circuit brake hardware, load balancing distribution valve	
King Pin		2", bolt - connected in DIN standards, interchangeable with 3.5"	
Landing Gears		Telescopic landing gears with two mechanical speeds; Dynamic: 25.000 kg, Static : 50.000 kg	
Electricity Hardware 'E certified'		24 V Lighting system, 7 pole distribution cable and required hardware for traffic regulation	
Standard Accessories		1 x spare tire holder, 1 x tool box, 1 x water tank, wheel chock and holder, FRP mudguard, ladder	

SEMITÜRK®



MODEL:
STET30A220

MODEL:
STUT30A202

EXCAVATION TYPE DUMPER SEMI TRAILER



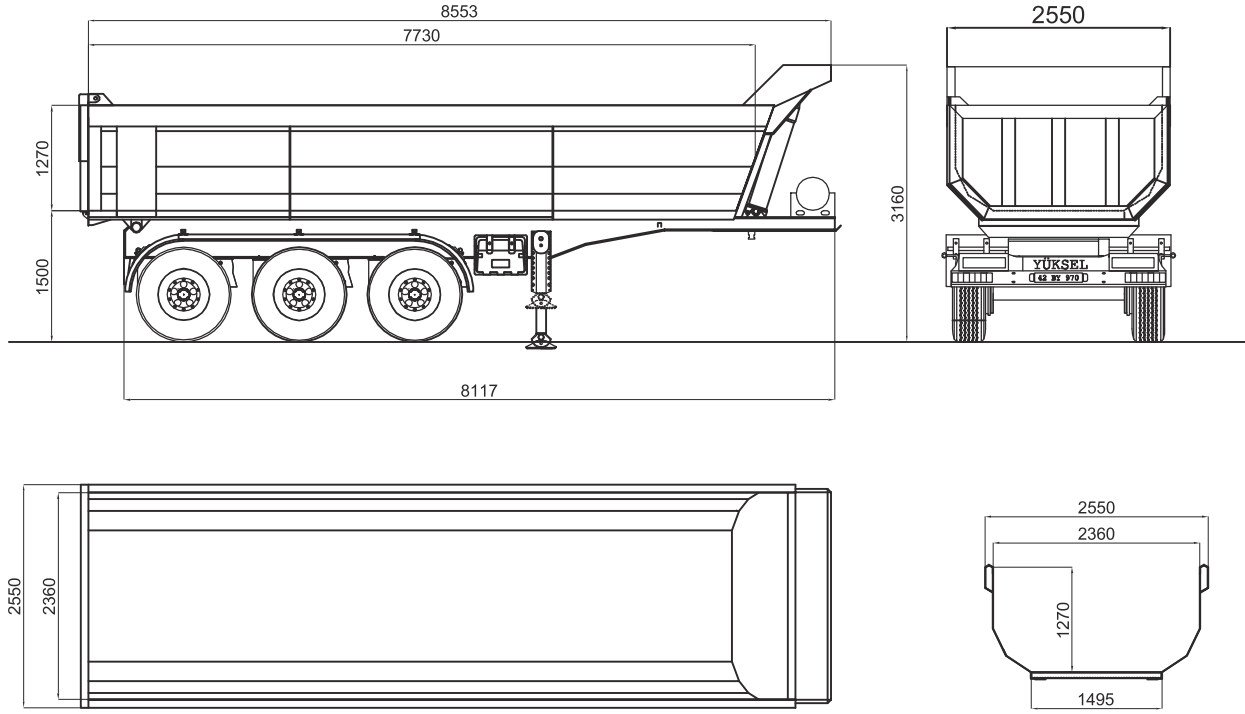

SEMITÜRK

DUMPER SEMI TRAILER		STET30A220	STUT30A202
Weight and Dimensions	Model Type	Excavation type	'U' type
	Length of Dumper	8.500 mm	7.730 mm
	Total Width	2.550 mm	2.550 mm
	Gates	1.600 mm	1.270 mm
	Dead Weight	8.750 kg	6.000 kg
Main Structure and Chassis		Main structure, chassis and other metal parts are produced from 'Hardox' 'ST 52' and 'Domex 700' material options	Main structure, chassis and other metal parts are produced from 'Hardox' 'ST 52' and 'Domex 700' material options
Tires		385 / 65 R 22.5" size 6 + 1 units tubeless tires	
Brake System		Dual circuit brake hardware, EBS, 2S/2M & 4S/2M	
King Pin		2", bolt - connected in DIN standards	
Landing Gears		Telescopic landing gears with two mechanical speeds; Dynamic: 25.000 kg, Static : 50.000 kg	
Axles		3 axles BPW compatible, 12 ton capacity, square section	
Suspension System		Air -suspension "5813", 100 mm Z-type springs, suspension valves and shock absorbers	
Electricity Hardware 'E certified'		24 V Lighting system, 7 pole distribution cable and required hardware for traffic regulation	
Standard Accessories		1 x spare tire holder, 1 x tool box, 1 x water tank, wheel chock and holder, FRP mudguard, ladder	

SEMITÜRK®



MODEL:
STFB20B207

MODEL:
STFB30S306

FLATBED SEMI - TRAILER



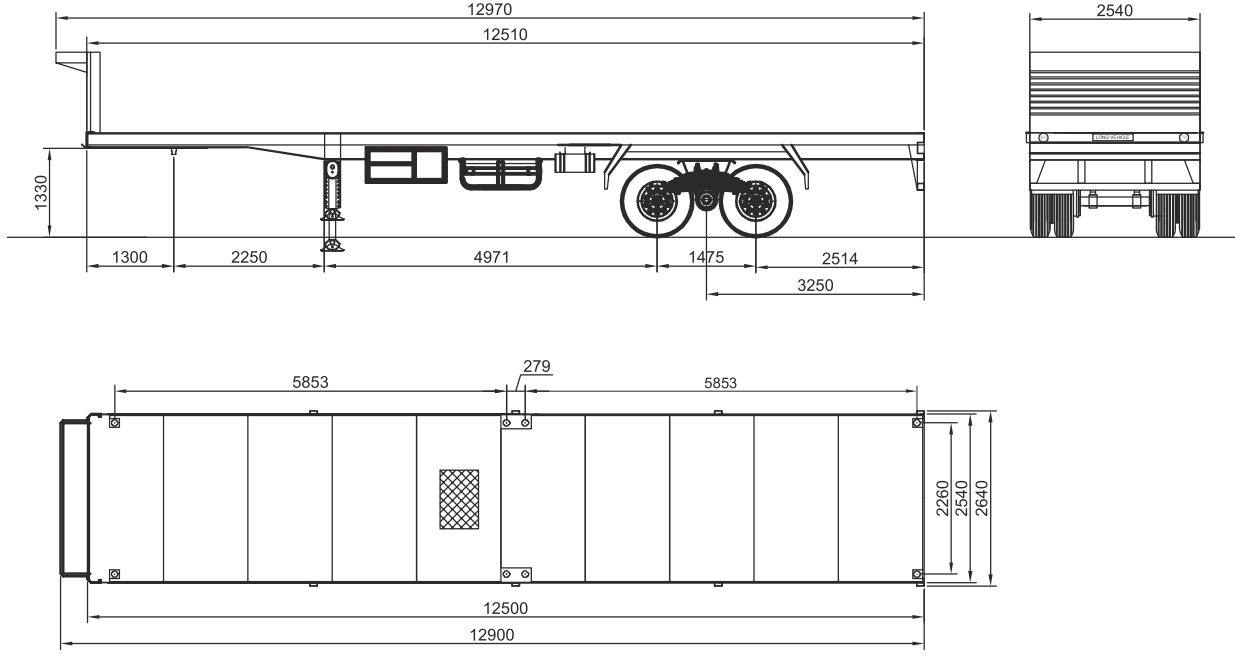

SEMITÜRK

FLATBED SEMI - TRAILER		STFB20B207	STFB30S306
Weight and Dimensions	Total Length	12.500 mm	13.600 mm
	Total Width	2.550 mm	2.550 mm
	Gates and Accessional Gates	—	1000 + 400 + 400 mm
Main Structure and Chassis		Chassis is produced from '400 mm IPE' metal Edges are produced from '180 mm NPI' metal Portable front wall is 1500mm 20" - 40" container locks	Chassis is produced from '450 mm IPE' metal Edges are produced from '180 mm NPI' metal Portable front wall is 1800 mm 20" - 40" container locks
Axle Group	Number of Axles	2 axles	3 axles
	Axle Capacity	16.000 kg	14.000 kg
	Tires	2 x 4 = 8 units 12R 22.5 tubeless 2 x 4 = 8 units 1200 x 24"	3 x 4 = 12 units 12R 22.5 tubeless 3 x 4 = 12 units 1200 x 24"
	Suspension System	Bogie 'heavy duty tandem' 100 x 12 spring suspension	
Brake System		Dual circuit brake hardware	
King Pin		2", bolt - connected in DIN standards, interchangeable with 3.5"	
Landing Gears		Telescopic landing gears with two mechanical speeds; Dynamic: 25.000 kg, Static : 50.000 kg	
Electricity Hardware 'E certified'		24 V Lighting system, 7 pole distribution cable and required hardware for traffic regulation	
Standard Accessories		1 x spare tire holder, FRP mudguard, ladder, 1 x tool box, 1 x water tank, wheel chock and holder	

SEMITÜRK®



MODEL:
STFB30A207

MODEL:
STLT30A204 FLATBED SEMI - TRAILER



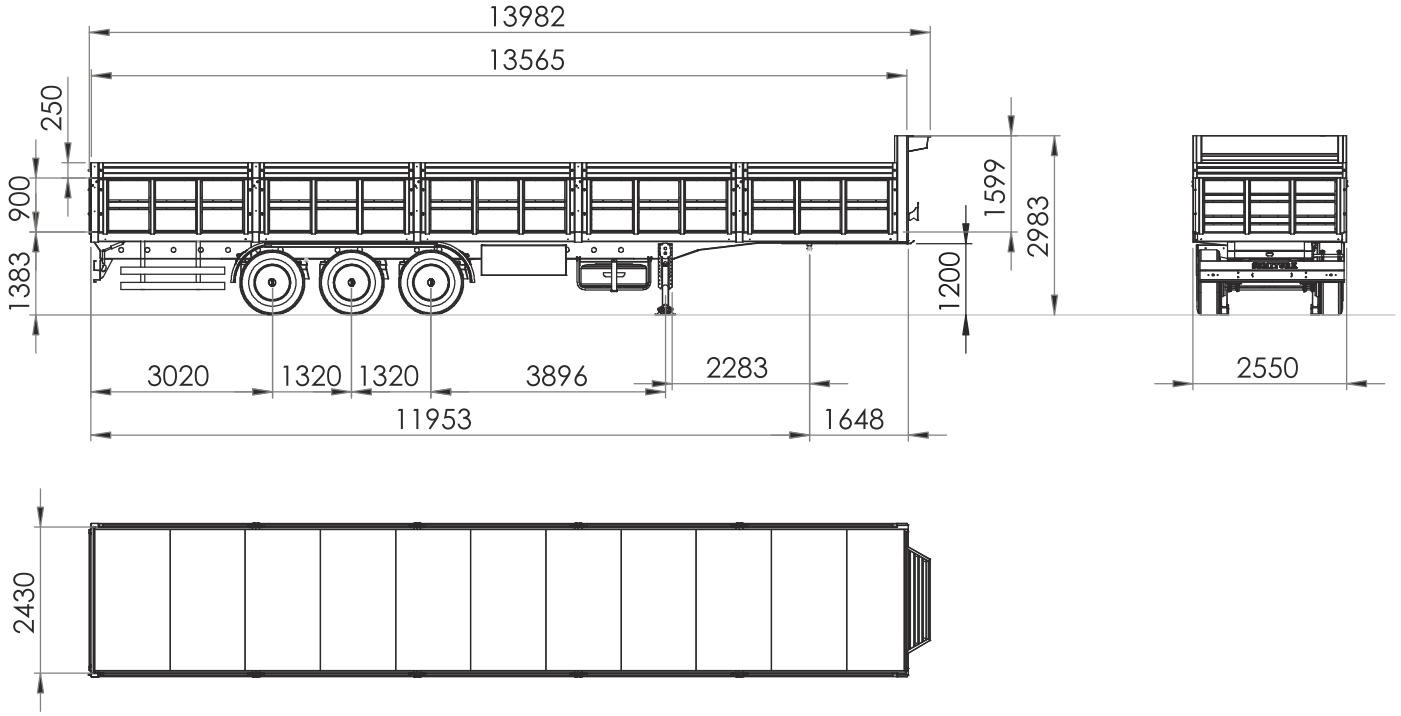

SEMITÜRK

FLATBED		STFB30A207	STLT30A204
Weight and Dimensions	Total Length	13.600 mm	13.600 mm
	Total Width	2.550 mm	2.550 mm
	Gates	—	850 mm
	Dead Weight	5.500 kg	6.200 kg
Main Structure and Chassis		Manufactured from 'ST52' material by submerged welding machine. Base plate is "3/4 mm checkered metal" 1500 mm portable front wall	Manufactured from 'ST52' material with using submerged welding machine. Base plate is "30 mm plywood". Gates are produced from 'Domex Docol'
Tires		385 / 65 R 22.5" size 6 + 1 units tubeless tires	
Brake System		Dual circuit brake hardware, EBS, 2S/2M & 4S/2M	
King Pin		2", bolt - connected in DIN standards	
Landing Gears		Telescopic landing gears with two mechanical speeds; Dynamic: 25.000 kg, Static : 50.000 kg	
Axles		3 axles BPW compatible, 12 ton capacity, square section	
Suspension System		Air -suspension "5813", 100 mm Z-type springs, suspension valves and shock absorbers	
Electricity Hardware 'E certified'		24 V Lighting system, 7 pole distribution cable and required hardware for traffic regulation	
Standard Accessories		1 x spare tire holder, 1 x tool box, 1 x water tank, wheel chock and holder, FRP mudguard, ladder	

SEMITÜRK®



MODEL:
STFB30A255

MODEL:
STFB30A265

CONTAINER CARRIER SEMI - TRAILER



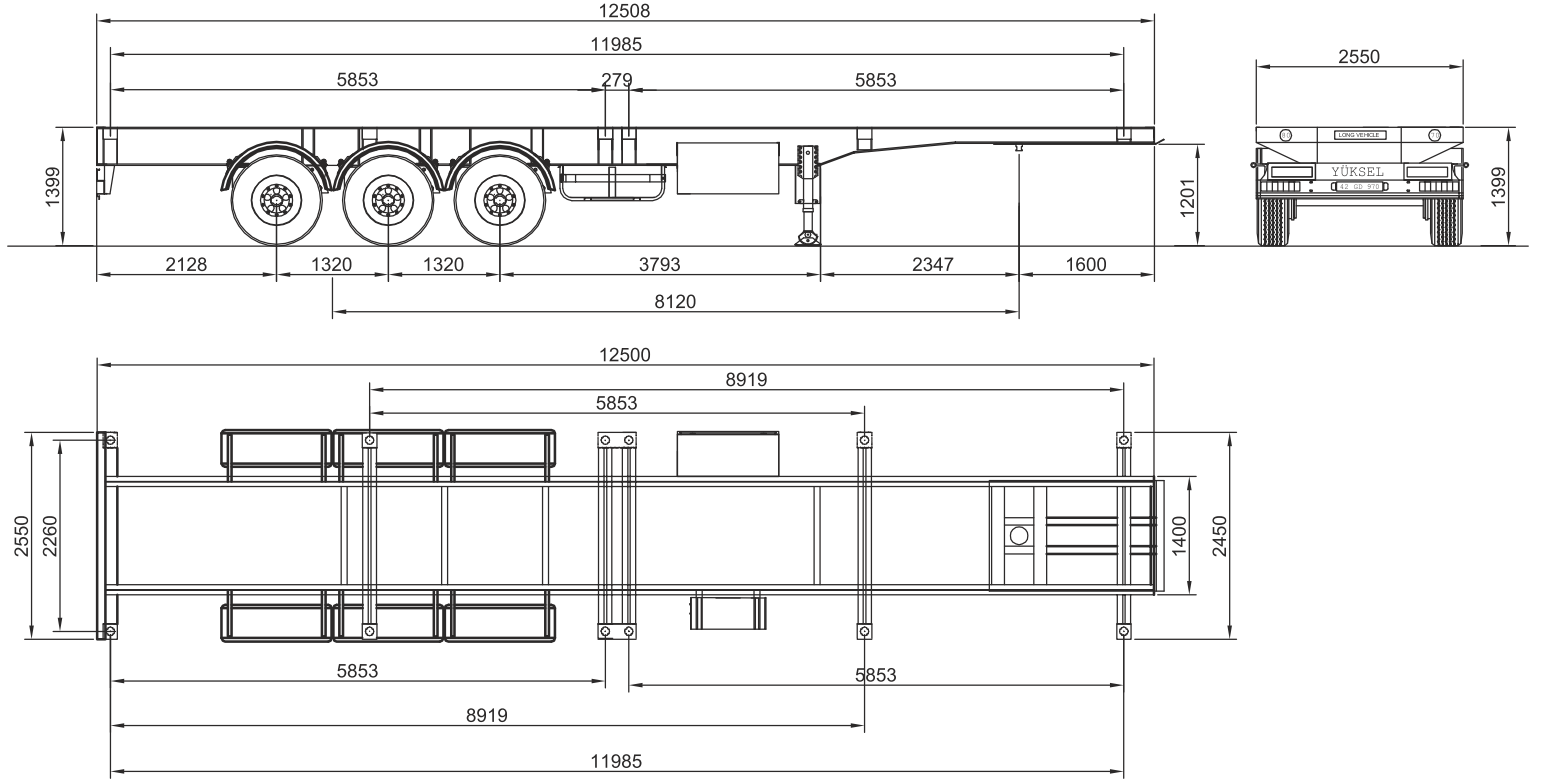

SEMITÜRK

SEMI - TRAILER		STFB30A255	STFB30A265
Weight and Dimensions	Model Type	20" Container carrier	40" Container carrier
	Total Length	7.549 mm	12.500 mm
	Total Width	2.550 mm	2.550 mm
	Gates	—	—
	Dead Weight	5.000 kg	5.500 kg
Main Structure and Chassis		Manufactured from 'ST52' material U-shaped reinforced carrier cross - members 4 x 20" Twist locks	Manufactured from 'ST52' material U-shaped reinforced carrier cross - members 4 x 20" Twist locks 4 x 40" Twist locks
Tires		385 / 65 R 22.5" size 6 + 1 units tubeless tires	
Brake System		Dual circuit brake hardware, EBS, 2S/2M & 4S/2M	
King Pin		2", bolt - connected in DIN standards	
Landing Gears		Telescopic landing gears with two mechanical speeds; Dynamic: 25.000 kg, Static : 50.000 kg	
Axles		3 axles BPW compatible, 12 ton capacity, square section	
Suspension System		Air - suspension "5813", 100 mm Z-type springs, suspension valves and shock absorbers	
Electricity Hardware 'E certified'		24 V lighting system, 7 pole distribution cable and required hardware for traffic regulation	
Standard Accessories		1 x spare tire holder, 1 x tool box, 1 x water tank, wheel chock and holder, FRP mudguard	

SEMITÜRK®



MODEL:
STHT51A210

BOTTOM HOPPER TYPE SEMI-TRAILER SET

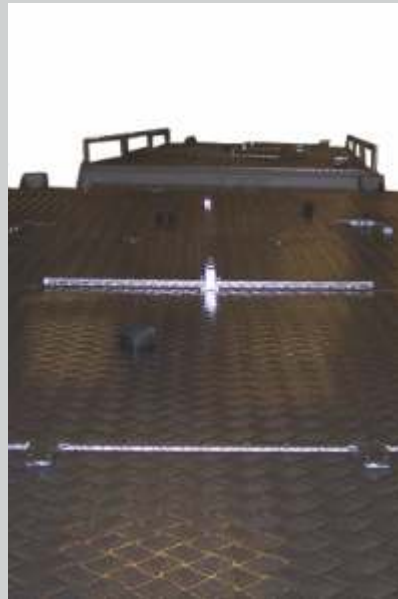

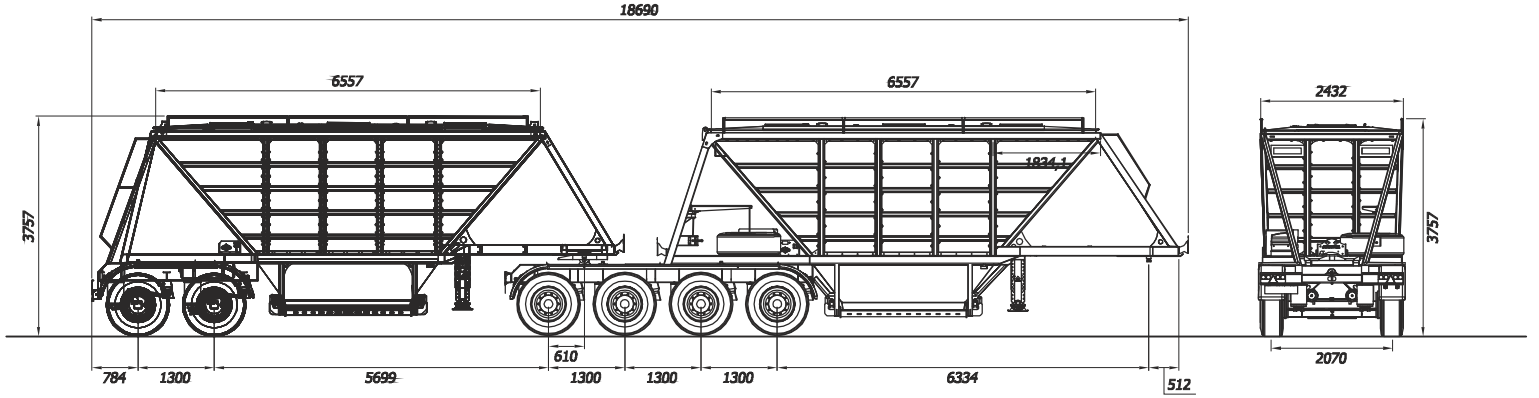

SEMITÜRK

BOTTOM HOPPER TYPE SEMI-TRAILER SET		STHT51A210
Weight and Dimensions	Length of Total Set	18.690 mm
	Total Width	2.500 mm
	Ground Clearance	3.757 mm
	Volume 2 X 28 m ³ "SET"	56 m ³
	Dead Weight 2 x 6000 kg	12.000 kg
	Carrying Capacity	70.000 kg
Main Structure and Chassis	Aluminium alloy bunker, chassis and frame from 'Domex'	
Tires	385 / 65 R 22.5" size 12 + 1 units tubeless tires	
Brake System	Dual circuit brake hardware, EBS, 4S/2M	
King Pin	2", bolt - connected in DIN standards, interchangeable with 3.5"	
Landing Gears	Telescopic landing gears with two mechanical speeds; Dynamic: 25.000 kg, Static : 50.000 kg	
Axles	6 axles BPW compatible, 12 ton capacity, square section	
Suspansiyon Sistemi	Air - suspension "5813", 100 mm Z-type springs, suspension valves and shock absorbers	
Electricity Hardware 'E certified'	24 V Lighting system, 7 pole distribution cable and required hardware for traffic regulation	
Standard Accessories	1 x spare tire holder, 1 x tool box, 1 x water tank, wheel chock and holder, FRP mudguard, ladder	

SEMITÜRK®



MODEL:
STKK20A100

MODEL:
STKK20A104 - 105

CLOSED CHEST DUMPER SEMI TRAILER



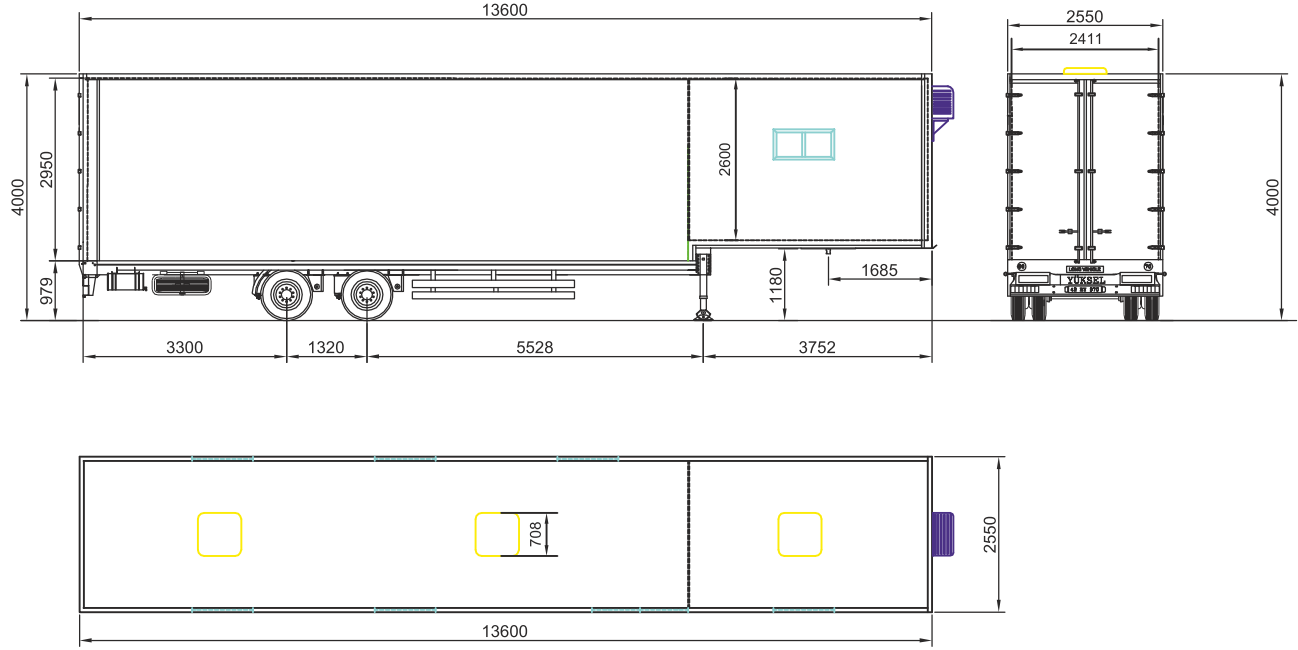

SEMITÜRK

CLOSED CHEST DUMPER SEMI - TRAILER	STKK20A100	STKK20A104	STKK20A105
Weight and Dimensions	Flat-box shaped	Right and left side walls are as scene and hydraulic 'manoeuvrable'	Hydraulic manoeuvrable internal body extendible as box-shape
	Special design and manufacturing are appropriated to intended use dimensions.		
Main Structure and Chassis	<p>Construction of trailer is built by 30 x 50 x 50 box profiles 3 mm thick outer coating 'coremat' will be reinforced with fiberglass sheets Internal coating is from 3 mm compact plate with desired colours and patterns (Laminate colours) External corners will completely be made of anodized aluminum profile 220 Volts 7.5 kva jen at the right - bottom of the trailer 2 units of mechanical balance support will stand at the back of the trailer 270 degrees opening double doors at the rear and there will be a 800 x 1900 mm service door within the right side door The floor is constructed with 'PVC' coated 18 mm 'plywood'</p>		
Tires	235 / 70 R 17.5" size 8 + 1 units tubeless tires		
Brake System	Dual circuit brake hardware, EBS, 2S/2M		
King Pin	2", bolt - connected in DIN standards		
Landing Gears	Telescopic landing gears with two mechanical speeds; Dynamic: 25.000 kg, Static : 50.000 kg		
Axles	2 axles BPW compatible, 9 ton capacity, square section		
Suspension System	Air - suspension "5813", 100 mm Z-type springs, suspension valves and shock absorbers		
Electricity Hardware 'E certified'	24 V Lighting system, 7 pole distribution cable and required hardware for traffic regulation		
Standard Accessories	1 x spare tire holder, 1 x tool box, 1 x water tank, wheel chock and holder, FRP mudguard, ladder		

SEMITÜRK®



MODEL:
STLB06H201

MODEL:
STLB08H201

LOWBED SEMI - TRAILER



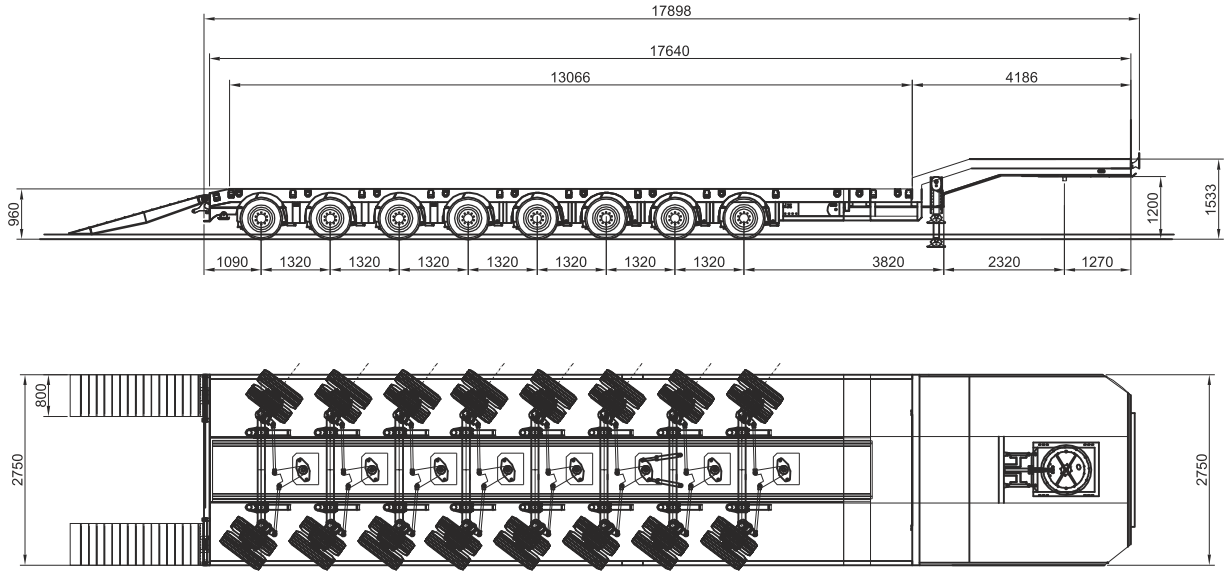

SEMITÜRK

LOWBED SEMI - TRAILER		STLB06H201	STLB08H201
Weight and Dimensions	Total Length	14.500mm	17.640 mm
	Total Width	2.750 mm	2.750 mm
	Side Extension Profiles	250 + 250 mm	250 + 250 mm
	Loading Deck Length	10.089 mm	13.066 mm
	Dead Weight	15.500 kg	17.500 kg
Main Structure and Chassis		"Manufactured from 'Domex 700' material with submerged welding machine. Floor base is made of wooden, 7/8 checkered metal."	"Manufactured from 'Domex 700' material with submerged welding machine. Floor base is made of wooden, 7/8 checkered metal."
Tires	235/75 R 17.5 Tubeless	6 x 4 24 tires	8 x 4 32 tires
Axle Group	Number of Axles	6 units	8 units
	Axle Capacity	12.000 kg	12.000 kg
	Number of Rotating Hydraulic Axle	6 of axles	8 of axles
Brake System		Dual circuit brake hardware, EBS, 2S/2M & 4S/2M	
King Pin		2", bolt - connected in DIN standards, interchangeable with 3.5"	
Landing Gears		Telescopic landing gears with two mechanical speeds; Dynamic: 25.000 kg, Static : 50.000 kg	
Suspension System		Air - suspension "5813", 100 mm Z-type springs, suspension valves and shock absorbers	
Electricity Hardware 'E certified'		24 V Lighting system, 7 pole distribution cable and required hardware for traffic regulation	
Standard Accessories		1 x spare tire holder, FRP mudguard, 1 x tool box, 1 x water tank, wheel chock and holder	
Additional Options		Hydraulic suspension and chassis extension options	

SEMITÜRK®



MODEL:
STLB30A201

MODEL:
STLB22A201

LOWBED SEMI TRAILER



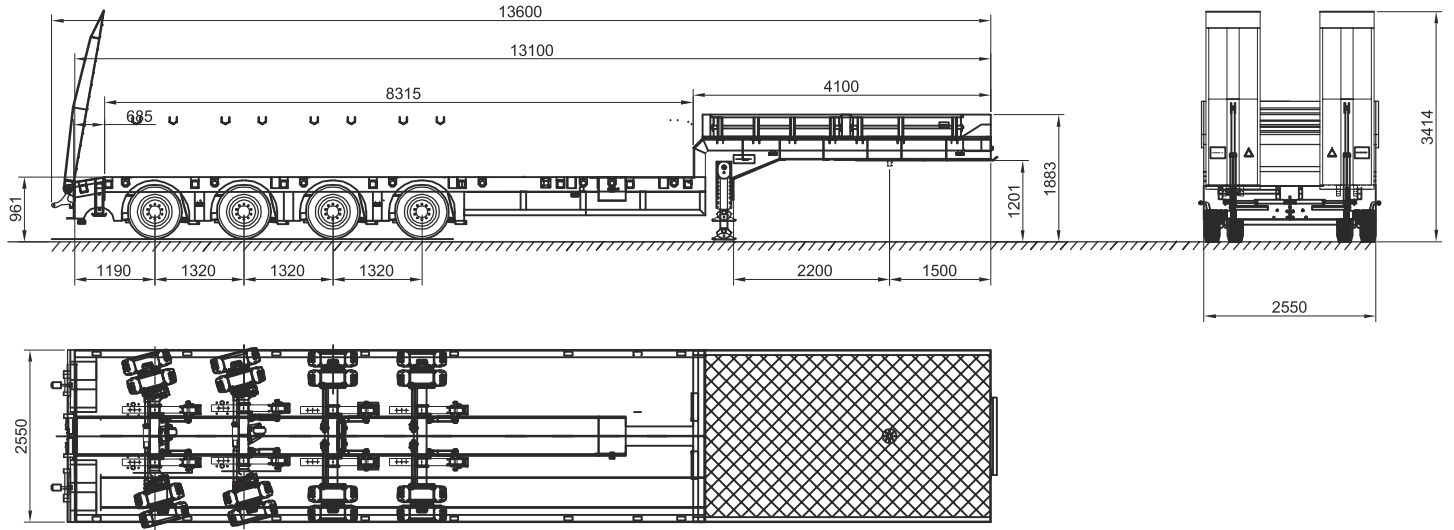

SEMITÜRK

LOWBED SEMI TRAILER		STLB30A201	STLB22A201
Weight and Dimensions	Total Length	13.600 mm	13.600 mm
	Total Width	2.550 mm	2.550 mm
	Side Extension Profiles	250 + 250 mm	250 + 250 mm
	Loading Deck Length	9.000 mm	9.000 mm
	Dead Weight	10.249 kg	12.750 kg
Main Structure and Chassis		Manufactured from 'Domex 700' material with submerged welding machine Base plate is '7/8 mm checkered metal'	Manufactured from 'Domex 700' material with submerged welding machine. Floor base is made of wooden, 7/8 checkered metal
Tires	235/75 R 17.5 Tubeless	3 x 4 12 tires	4 x 4 16 tires
Axle Group	Number of Axles	3 axles	4 axles
	Axle Capacity	12.000 kg	12.000 kg
	Number of Rotating Hydraulic Axle	—	2 of axles
Brake System		Dual circuit brake hardware, EBS, 2S/2M & 4S/2M	
King Pin		2", bolt - connected in DIN standards, interchangeable with 3.5"	
Landing Gears		Telescopic landing gears with two mechanical speeds; Dynamic: 25.000 kg, Static : 50.000 kg	
Suspension System		Air - suspension "5813", 100 mm Z-type springs, suspension valves and shock absorbers	
Electricity Hardware 'E certified'		24 V Lighting system, 7 pole distribution cable and required hardware for traffic regulation	
Standard Accessories		1 x spare tire holder, FRP mudguard, 1 x tool box, 1 x water tank, wheel chock and holder	
Additional Options		Chassis extension options	

SEMITÜRK®



MODEL:
STLB32A201

MODEL:
STLB33A201 LOWBED SEMI - TRAILER



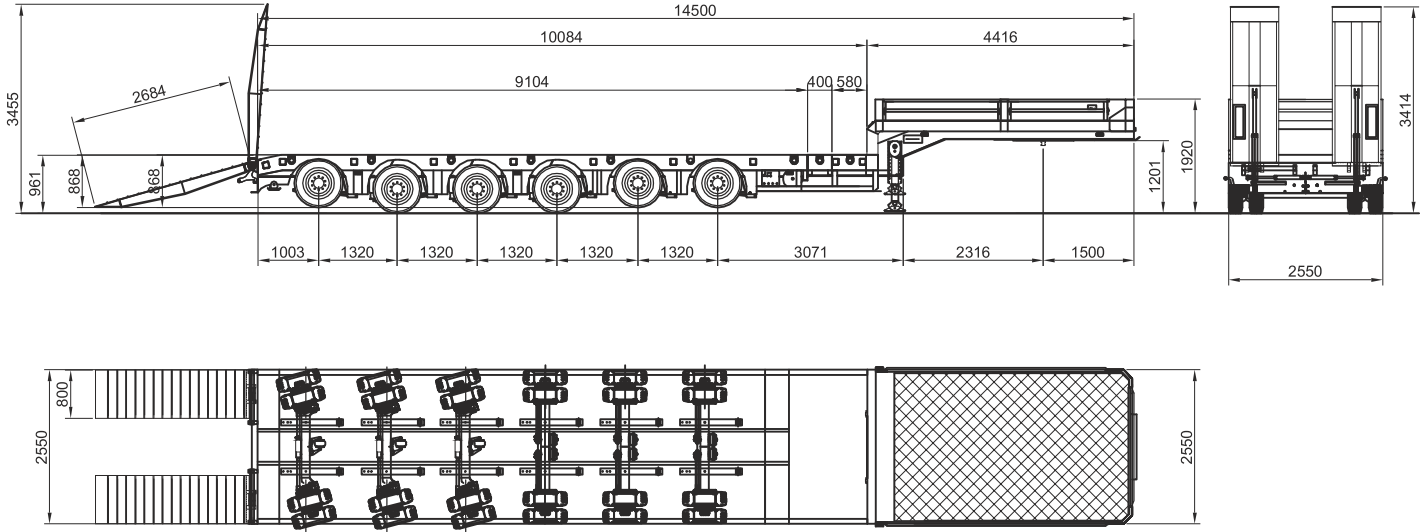

SEMITÜRK

LOWBED SEMI - TRAILER		STLB32A201	STLB33A201
Weight and Dimensions	Total Length	13.600 mm	14.500 mm
	Total Width	2.550 mm	2.550 mm
	Side Extension Profiles	250 + 250 mm	250 + 250 mm
	Loading Deck Length	9.000 mm	10.000 mm
	Dead Weight	13.800 kg	14.850 kg
Main Structure and Chassis		Manufactured from 'Domex 700' material with submerged welding machine Base plate is '7/8 mm checkered metal	Manufactured from 'Domex 700' material with submerged welding machine. Floor base is made of wooden, 7/8 checkered metal
Tires	235/75 R 17.5 Tubeless	5 x 4 20 tires	6 x 4 24 tires
Axle Group	Number of Axles	5 axles	6 axles
	Axle Capacity	12.000 kg	12.000 kg
	Number of Rotating Hydraulic Axle	2 of axles	3 of axles
Brake System		Dual circuit brake hardware, EBS, 2S/2M & 4S/2M	
King Pin		2", bolt - connected in DIN standards, interchangeable with 3.5"	
Landing Gears		Telescopic landing gears with two mechanical speeds; Dynamic: 25.000 kg, Static : 50.000 kg	
Suspension System		Air - suspension "5813", 100 mm Z-type springs, suspension valves and shock absorbers	
Electricity Hardware 'E certified'		24 V Lighting system, 7 pole distribution cable and required hardware for traffic regulation	
Standard Accessories		1 x spare tire holder, FRP mudguard, 1 x tool box, 1 x water tank, wheel chock and holder	
Additional Options		Chassis extension options	

SEMITÜRK®



MODEL:
STTT30A220 TANKER SEMI - TRAILER



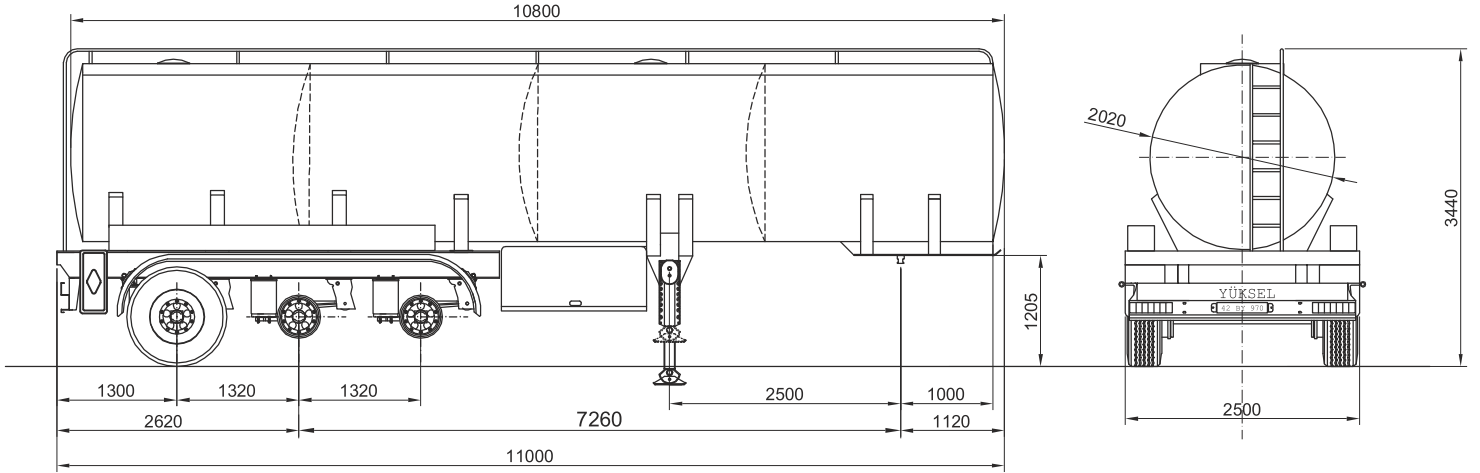

SEMITÜRK

TANKER SEMI - TRAILER	STTT30A220
Weight and dimensions	Manufactured is done due to optional volume dimensions
Main Structure / Chassis	<p>Manufactured from 'ST52' metal with using submerged welding machine as half chassis monobloc or whole chassis</p> <p>Bolt connected side support profiles appropriate to chassis section</p> <p>Tank shell plate is made of 4mm ST37 A1 quality sheet</p> <p>5 units wave breaker appropriated to EEC regulations 40mm wide, 4 manhole covers 2 units</p> <p>3" diemeter outlet valve with 3 header pipe and 2 discharging pipe system. Drain pipe and discharging valve Tested under 0.35 bar pressure</p>
Tires	385 / 65 R 22.5" size 6 + 1 units tubeless tires
Brake System	Dual circuit brake hardware, EBS, 2S/2M & 4S/2M
King Pin	2", bolt - connected in DIN standards
Landing Gears	Telescopic landing gears with two mechanical speeds; Dynamic: 25.000 kg, Static : 50.000 kg
Axles	3 axles BPW compatible, 12 ton capacity, square section
Suspension System	Air -suspension "5813", 100 mm Z-type springs, suspension valves and shock absorbers
Electricity Hardware "E certified"	24 V Lighting system, 7 pole distribution cable and required hardware for traffic regulation
Standard Accessories	1 x spare tire holder, 1 x tool box, 1 x water tank, wheel chock and holder, FRP mudguard, rising ladder, ladder 6.5 meters long hose carriers with covers and locks, top platform and treadmill