

SEMITÜRK®



MODEL:
STKK20A100

MODEL:
STKK20A104 - 105

CLOSED CHEST DUMPER SEMI TRAILER



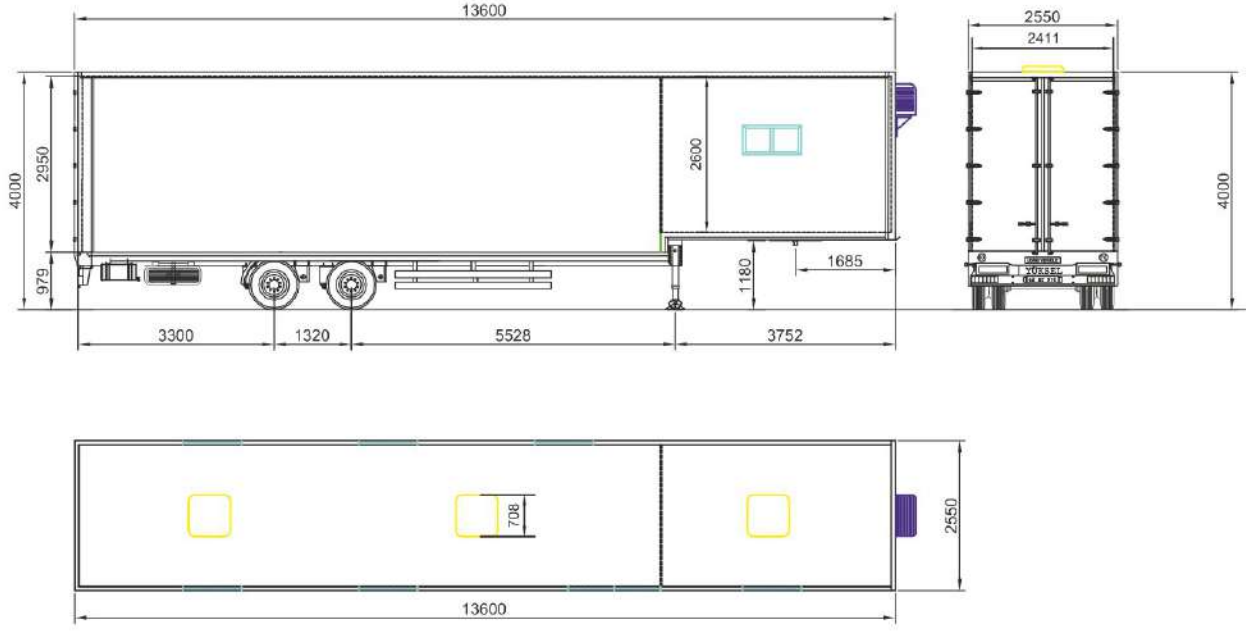

SEMITÜRK

CLOSED CHEST DUMPER SEMI - TRAILER	STKK20A100	STKK20A104	STKK20A105
Weight and Dimensions	Flat-box shaped	Right and left side walls are as scene and hydraulic 'manoeuvrable'	Hydraulic manoeuvrable internal body extendible as box-shape
Special design and manufacturing are appropriated to intended use dimensions.			
Main Structure and Chassis	<p>Construction of trailer is built by 30 x 50 x 50 box profiles 3 mm thick outer coating 'coremat' will be reinforced with fiberglass sheets Internal coating is from 3 mm compact plate with desired colours and patterns (Laminate colours) External corners will completely be made of anodized aluminum profile 220 Volts 7.5 kva jen at the right - bottom of the trailer 2 units of mechanical balance support will stand at the back of the trailer 270 degrees opening double doors at the rear and there will be a 800 x 1900 mm service door within the right side door The floor is constructed with 'PVC' coated 18 mm 'plywood'</p>		
Tires	235 / 70 R 17.5" size 8 + 1 units tubeless tires		
Brake System	Dual circuit brake hardware, EBS, 2S/2M		
King Pin	2", bolt - connected in DIN standards		
Landing Gears	Telescopic landing gears with two mechanical speeds; Dynamic: 25.000 kg, Static : 50.000 kg		
Axles	2 axles BPW compatible, 9 ton capacity, square section		
Suspension System	Air - suspension "5813", 100 mm Z-type springs, suspension valves and shock absorbers		
Electricity Hardware 'E certified'	24 V Lighting system, 7 pole distribution cable and required hardware for traffic regulation		
Standard Accessories	1 x spare tire holder, 1 x tool box, 1 x water tank, wheel chock and holder, FRP mudguard, ladder		